

# TECHNICAL DATASHEET

## EXPANSION JOINT PROFILES

### AR 154-050

#### Aluminium Expansion Joint Profile Floor Profiles (Over Finishing)

- Mill finish aluminium profile.
- Replaceable TPE insert.
- Easy onsite installation.
- Suitable for granite, ceramic and Vinyl flooring.
- Ideal shopping malls ...etc.



**Movement Capacity  $\pm 10$  mm**

**Product  
Instructor**

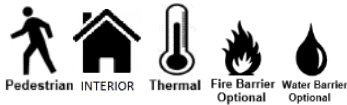

- ❖ Standard colors: black, gray and cream.
- ❖ Profile length: 3 lm, insert length: 25 lm.
- ❖ Smooth insert is also available.
- ❖ For fire and water barriers installation, please ask for our technical advice.

Profile Code	Joint Width W	Total Movement	Surface Width SW	Installation Depth H	Load Capacity
AR 154-050	50 mm	$\pm 10$ mm	140 mm	15 mm	Pedestrian
AR 154-050K	50 mm	$\pm 10$ mm	95 mm	15 mm	Pedestrian

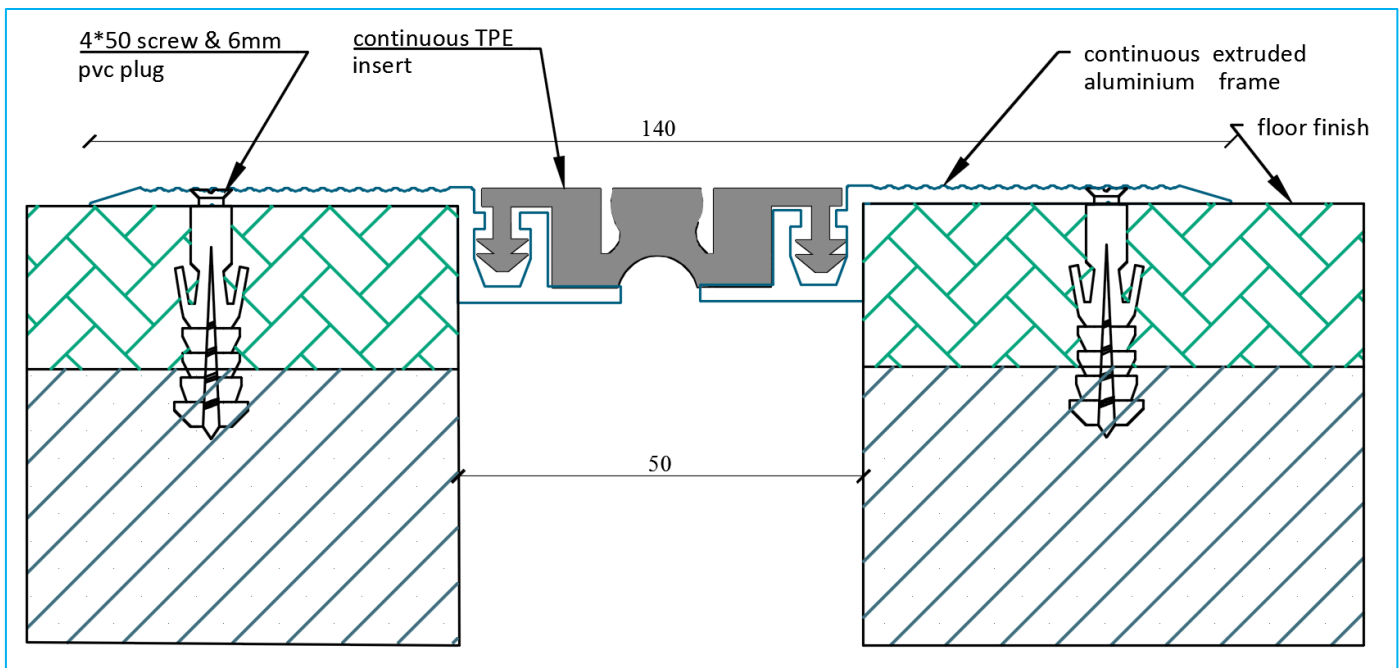

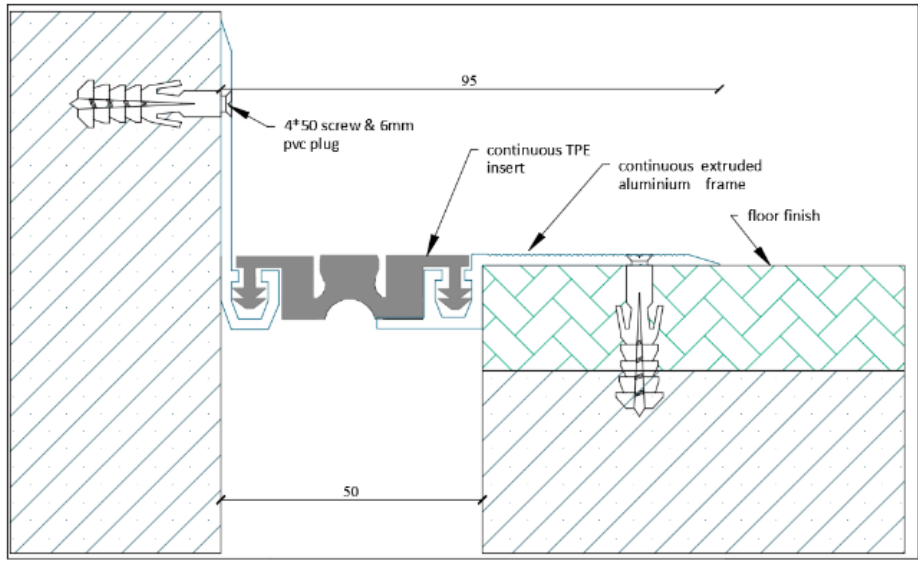

smooth insert an alternative



-4\*50 mm wooden screw and 6 mm plastic plug between 45 cm distance from both sides of profile. If the facade height is more than 15 meters installer must apply polyurethane sealant into channel of aluminium profile to prevent sliding of rubber

### Materials Specifications

Aluminium Alloy 6063.T5 Chemical Properties

	Si	Fe	Cu	Mn	Mg	Zn	Ti	Cr
<b>Standard of 6063T5 (EN 573-3)</b>	0.20 0.60	Max 0.35	Max 0.10	Max 0.10	0.45 0.90	Max 0.10	Max 0.10	Max 0.10
<b>Measured Values</b>	0.458	0.239	0.0161	0.0804	0.524	0.0201	0.0106	0.0049

Aluminium Alloy 6063.T5 Physical Properties

Specialities	Unit	Value
Density	gm/cm <sup>3</sup>	2,71
Thermal Expansion	(200-100 C°)/C°	23*10
Elastic Module Tension	Kg/mm <sup>2</sup>	6900
Tensile Strength	at 24 C°Kg/mm <sup>2</sup>	15,5
Elongation	Delta L/L*100 (50 mm)	8%
Hardness	Kg/mm <sup>2</sup> Brinel (HB)	60-65
Yield Strength	Kg/mm <sup>2</sup>	12
Shear Strength	Kg/mm <sup>2</sup>	11,5
Thickness of the paint	Micron	60-90
Thickness of the anadise	Micron	10-12

TPE Physical Properties

Physical Properties	ASTM Test Method	Requirements
Tensile Strength	D-412	850 psi
Elongation at break	D412	300%
Hardness Shore A	D-2240	67±3
100% Modulus,min	D-412	275 psi
Tear Strength	D-624	140 lbs/in
Tension set ,avg	D-412	10%
Compression set max 22 hrs@73°F / 22 hrs@257°F ,max	D-395	35% 45%
Ozone Resistance	D-1171	No cracks
UV resistance	SAE J1960	Pass
Staining resistance	D-925	No staining